

# MASABA®



## FULL PRODUCT CATALOG





OUR STORY

Harold Higman Sr. founded Higman Sand & Gravel in 1939. Times were challenging and equipment was scarce, so Harold relied on ingenuity and innovation to design his own machinery. Taking these lessons to heart, his son, Harold Higman Jr., continued this tradition, building equipment tough enough to endure the rigorous demands of quarries and mining — ultimately leading to the founding of Masaba in 1962.

In 1999, Harold Jr.'s son, Jerad, returned to the company and became Masaba's CEO. With a background in mechanical engineering and hands-on experience gained from working alongside his father and grandfather, Jerad had developed a deep understanding of how to design and build some of the most rugged equipment in the industry.

To support the company's growth, Jerad established a new 20,000 sq. ft. facility in Akron, Iowa, in 2000. As Masaba continued to expand its product line and customer base, a larger 100,000 sq. ft. manufacturing facility was built in Vermillion, South Dakota, in 2005.

To accommodate growth of the Magnum product line and Masaba's engineering department, a 60,000 sq. ft. addition was completed in 2008. In 2012, another 51,000 sq. ft. was added to the facility, featuring one of the largest sandblast and paint booths in the tri-state area, as well as advanced machine centers and fabrication equipment. Now spanning 211,000 sq. ft., this facility allows Masaba to manage every aspect of design and production in-house, ensuring the highest quality for each project.

As Masaba expanded globally, Masaba Canada was established in 2009, and a new 30,000 sq. ft. manufacturing plant was built in Ontario. Masaba Canada operates as a separately owned entity.

In 2024, Masaba began construction on a new state-of-the-art steel and metal fabrication facility. This 145,000 sq. ft. building, located adjacent to the main facility in Vermillion, will open in 2025.

Masaba has put together a world-class team dedicated to designing and manufacturing rugged equipment that is built to last, meeting the needs of customers around the world.



| 1939   | 1962   | 1999                                     | 2000   | 2005   |
|--|--|--|--|--|
| Harold Higman Sr. establishes Higman Sand & Gravel | Harold Higman Jr. launches Masaba in Akron, IA | Jerad Higman takes over as CEO of Masaba | New 20,000 sq. ft. facility constructed in Akron, IA | Masaba relocates to 100,000 sq. ft. facility in Vermillion, SD |

| 2008   | 2009                                 | 2012   | 2025   |
|--|--------------------------------------|--|--|
| Additional 60,000 sq. ft. added to the Vermillion facility | Masaba Canada established in Ontario | 51,000 sq. ft. added for new blast and paint booth | New 145,000 sq. ft. steel fabrication facility opens |

CONTENTS

Conveying & Material Handling

Magnum Telescoping Conveyor..... 4-7

Truck Unloaders ..... 8-9

Portable Radial Stackers ..... 10-11

Self-Contained Stackers ..... 12

Roll-Off & Stackable Conveyors ..... 13

Sand Wagons ..... 14

Bins, Hoppers, & Feeders..... 15

Portable & Stationary Chassis

Crushing Plants..... 16

Screen Plants..... 17

Wash Plants..... 18

Fine Material Washers ..... 19

Custom Conveyors & Plants..... 20-21

Dealer Network..... 22

Service, Support, & Parts ..... 23







## MASABA'S PATENTED TRACK DRIVES

- Masaba's patented designs ensure continuous engagement and smoother stinger operation, enhancing long-term durability and reducing maintenance needs.
- Unlike winch systems, there are no cable maintenance concerns, eliminating the risk of cable breakage and uncontrolled rollback.
- Masaba's load roller supports provide even load distribution across all support rollers, reducing fatigue stress on critical components and extending the life of the equipment.



### SINGLE DRIVE

Single Gearbox with Mechanical Brake  
QD Bushed Pin Hubs w/ Hardened Pins  
Keyed & Press Fit Gearbox Connection  
Four Maintenance Free Support Rollers

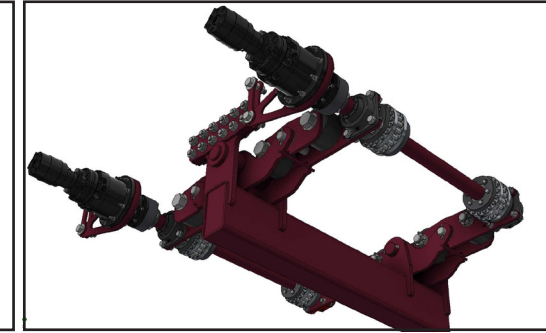

### DUAL DRIVE

Dual Gearbox with Dual Mechanical Brakes  
QD Bushed Pin Hubs w/ Hardened Pins  
Keyed & Press Fit Gearbox Connection  
Eight Maintenance Free Support Rollers

## Magnum Telescoping Conveyor

### THE MOST RUGGED TELESCOPING CONVEYOR IN THE WORLD

Masaba's Magnum Telescoping Conveyor stands out as the safest and most durable option available. Its patented design ensures constant engagement and smoother operation of the stinger, enhancing long-term durability and reducing maintenance needs. With lengths ranging from 100 to 195 feet, the Magnum line offers a solution for numerous applications. If our standard models don't meet your requirements, we specialize in custom engineering to deliver a conveyor tailored to your specific needs.

### WORLD-CLASS AUTOMATION

Masaba's Programmable Logic Control (PLC) system, equipped with a large color touchscreen HMI, offers intuitive interaction and excellent visibility. The PLC, combined with variable-speed wheel drives, ensures the production of high-quality, desegregated stockpiles. Three encoders work alongside the PLC to precisely track the X, Y, and Z positions of the head pulley. Additionally, four customizable programs allow users to select their preferred stockpiling configuration.



## AXLE/DRIVE UNDERCARRIAGE OPTIONS

Masaba offers multiple axle drive system configurations to suit your needs in the field.



### Folding Axle

Masaba's Folding Axle (FA) system enables easy transitions between operational and transport positions, with axles that can be hydraulically raised or lowered independently or together. Available in 2-wheel and 4-wheel drive models, the FA system suits various operational needs.

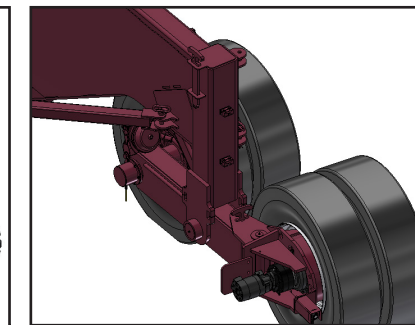

### Swing Axle with Hydra Shift

The Hydra Shift option streamlines the setup process and cuts down on maintenance time by eliminating the need for chains and sprockets. With Hydra Shift, operators can easily engage and disengage the drive by simply flipping a lever on the hub.

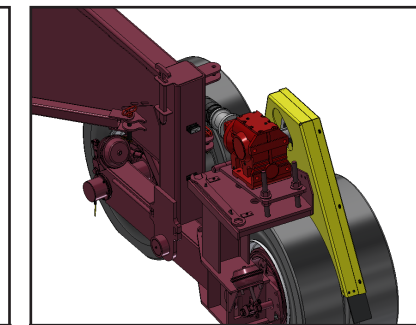

### Swing Axle with Chain & Sprocket

The Swing Axle (SA) system offers the industry's widest and most stable radial footprint. Its variable-speed wheel drive ensures even material distribution within the pile, resulting in fully desegregated stockpiles. An optional 4-wheel drive system guarantees reliable traction in the field.







High-Profile



Low-Profile



| MAGNUM STANDARD CONFIGURATIONS – LPFA |        |        |        |        |         |         |         |
|---------------------------------------|--------|--------|--------|--------|---------|---------|---------|
| Conveyor Length                       | 100'   | 110'   | 130'   | 140'   | 150'    |         |         |
| Belt Width (Inches)                   | 36     | 36     | 36     | 36     | 30      | 36      | 42      |
| Capacity (TPH)                        | 800    | 800    | 1000   | 1000   | 500     | 1000    | 1500    |
| Operational Dimensions                |        |        |        |        |         |         |         |
| Max Discharge Height                  | 33' 6" | 40' 6" | 41' 8" | 43'    | 46' 3"  | 46' 3"  | 46' 3"  |
| Pile Volume in Tons (@100 PCF)        |        |        |        |        |         |         |         |
| 90°                                   | 12,900 | 18,400 | 28,800 | 37,200 | 46,600  | 46,600  | 46,600  |
| 180°                                  | 23,100 | 32,900 | 51,600 | 66,500 | 83,400  | 83,400  | 83,400  |
| 270°                                  | 33,400 | 47,500 | 74,400 | 95,900 | 120,100 | 120,100 | 120,100 |

LPFA = Low-Profile Fold Axle | LPSA = Low-Profile Swing Axle | HPSA = High-Profile Swing Axle  
Tugger options available upon request. Pit-portable configurations available.

| MAGNUM STANDARD CONFIGURATIONS – HPSA |        |        |        |         |         |         |         |         |         |         |         |         |         |
|---------------------------------------|--------|--------|--------|---------|---------|---------|---------|---------|---------|---------|---------|---------|---------|
| Conveyor Length                       | 130'   |        |        | 150'    |         |         |         | 170'    |         |         | 190'    |         |         |
| Belt Width (Inches)                   | 36     | 42     | 48     | 30      | 36      | 42      | 48      | 36      | 42      | 48      | 36      | 42      | 48      |
| Capacity (TPH)                        | 1000   | 1500   | 2000   | 800     | 1000    | 1500    | 2000    | 1000    | 1500    | 2000    | 1000    | 1500    | 2000    |
| Operational Dimensions                |        |        |        |         |         |         |         |         |         |         |         |         |         |
| Max Extended Discharge Height         | 47' 8" | 47' 6" | 49'    | 52' 4"  | 52' 4"  | 51' 4"  | 51' 6"  | 60' 7"  | 57' 9"  | 58' 3"  | 63' 11" | 66' 5"  | 66' 5"  |
| Pile Volume in Tons (@100 PCF)        |        |        |        |         |         |         |         |         |         |         |         |         |         |
| 90°                                   | 36,600 | 36,600 | 36,700 | 52,100  | 52,100  | 52,100  | 53,100  | 73,100  | 73,100  | 71,800  | 104,000 | 104,000 | 104,000 |
| 180°                                  | 65,100 | 65,100 | 65,100 | 92,700  | 92,600  | 92,600  | 94,500  | 129,800 | 129,800 | 127,300 | 184,800 | 184,800 | 184,800 |
| 270°                                  | 93,500 | 93,500 | 93,600 | 133,200 | 133,200 | 133,200 | 135,900 | 186,400 | 186,400 | 182,700 | 265,500 | 265,500 | 265,500 |

Custom Magnum options are available, with larger belt widths offered upon request. Contact us for more details.  
NOTE: Dimensions may vary depending on axle configurations, options, and other factors. All dimensions are subject to change. For specific model dimensions and drawings, please contact us.





## Truck Unloaders

Reduce labor, fuel, and maintenance costs by minimizing the need for multiple material handling with Masaba Truck Unloaders. Whether you require a stationary unloading system or a fully portable solution, Masaba's engineers will collaborate with you to create the ideal Truck Unloader for your operation. Masaba offers standard widths of 48 inches and 72 inches for low-profile drive-over Truck Unloaders.

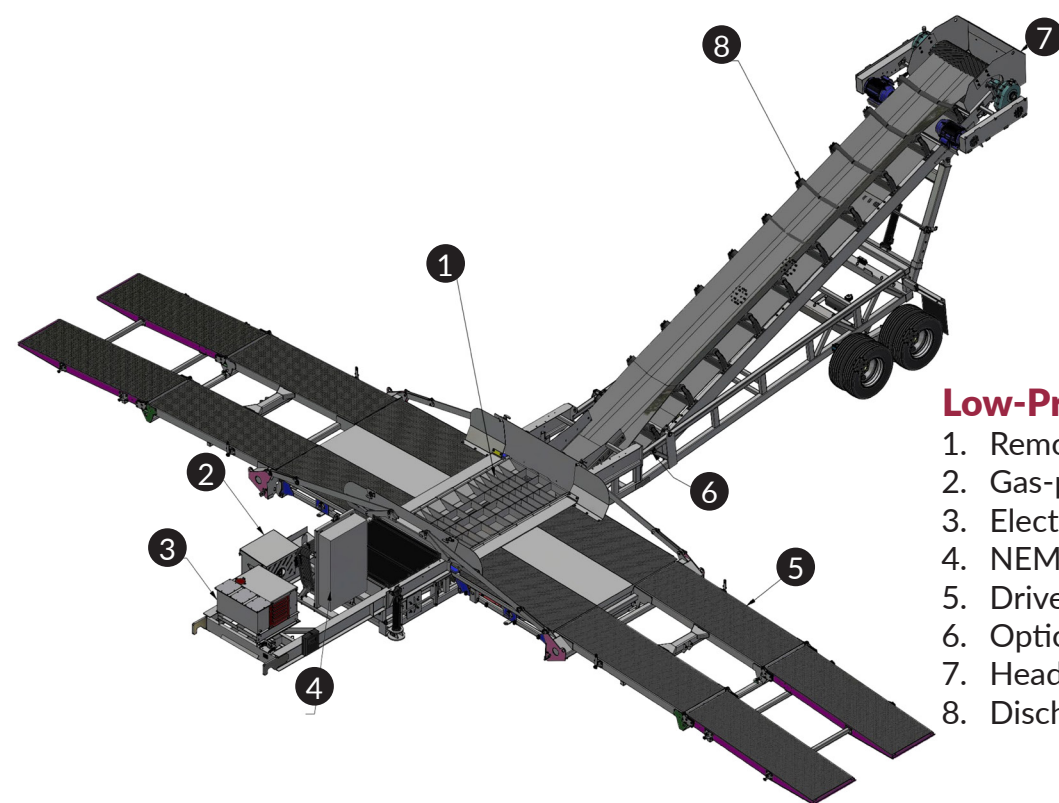

### Low-Profile Truck Unloader

1. Removeable drive-over grate
2. Gas-powered hydraulic power unit
3. Electric auxillary hydraulic pump
4. NEMA 4 control panel
5. Drive-over ramps
6. Optional intraflo central grease system
7. Headchute with bolt-in liners
8. Discharge conveyor



### Patented Triple-Ramp Options

1. Power deploy 2nd ramp and manual deploy 3rd ramp
2. Power deploy 3rd ramp



### Discharge Hood

With AR liners to feed 36" belt width or greater.



### Wireless Remote Control

Easily cycle your ramps from the comfort of your cab.







# Portable Radial Stackers

## THE MOST DURABLE RADIAL STACKERS AVAILABLE

For generations, Masaba has continually worked to design and enhance the most durable and reliable Radial Stacker conveyors available. Masaba's portable conveyor systems allow for a quick and seamless transition from travel mode to full operation. Stationary stackers are also available.

If you appreciate robust, high-performance machinery that delivers convenience and reliability, let Masaba's engineering team collaborate with you to create the ideal solution.

### Pile Volume of Radial Stacker Base Model Configurations

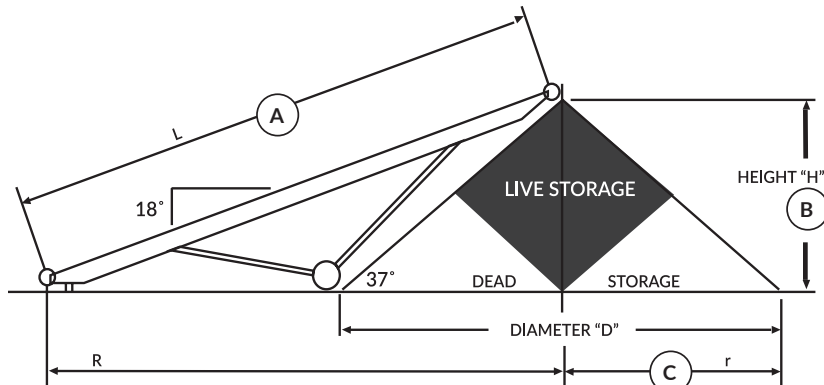

| STOCKPILE VOLUME<br>(TONS BASED ON 100 PCF OF MATERIAL, CONVEYOR INCLINE 18°, STOCKPILE ANGLE OF REPOSE 37°) |        |        |        |        |
|--|--------|--------|--------|--------|
| (A) Conveyor Length  | 60'    | 80'    | 100'   | 125'   |
| (B) Maximum Pile Height  | 20' 4" | 27.5'  | 32.5'  | 39.5'  |
| (C) Stockpile Radius   | 27'    | 36.5'  | 43'    | 52.5'  |
| Conical Pile Volume (Tons)   | 783    | 1,918  | 3,145  | 5,714  |
| 90°  | 3,339  | 8,020  | 13,819 | 25,066 |
| 180°   | 5,895  | 14,122 | 24,493 | 44,414 |
| 270°   | 8,451  | 20,224 | 35,167 | 63,764 |
| Each Degree of Arc Rate  | 28.4   | 67.8   | 118.6  | 215    |

Formula for Pile Volume: (Degree of Arc Rate \* Degree of Arc) + Original Conical Pile Tonnage = Total Pile Volume  
 Live storage at center of pile is theoretically 25% of total volume.

**Capacity:**  
 TPH Based on 100 PCF 400 FPM  
 » 30" Belt = 500 TPH  
 » 36" Belt = 750 TPH

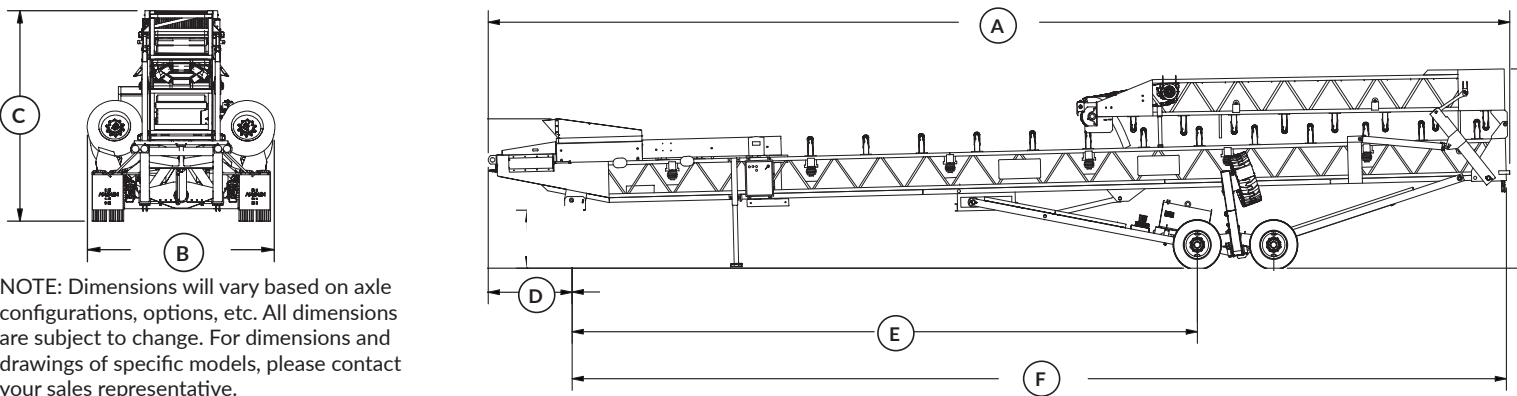

NOTE: Dimensions will vary based on axle configurations, options, etc. All dimensions are subject to change. For dimensions and drawings of specific models, please contact your sales representative.

| TRAVEL DIMENSIONS (BASED ON 36" BELT WIDTH) |          |             |               |                |                   |                        |
|---|----------|-------------|---------------|----------------|-------------------|------------------------|
| Conveyor Length                             | 60'      | 80' no fold | 80' head fold | 100' head fold | 100' FA head fold | 125' FA axle dual fold |
| (A) Total Length                            | 63' 2.5" | 84' 8.5"    | 68'           | 80' 2"         | 73' 6.5"          | 70' 10.5"              |
| (B) Width                                   | 11' 10"  | 11' 11"     | 11' 11.5"     | 11' 11.5"      | 11' 11"           | 11' 11.5"              |
| (C) Height                                  | 12'      | 13' 8.5"    | 14' 1"        | 14' 1"         | 13' 9"            | 13' 11"                |
| (D) Kingpin to End of Tow Eye               | 3' 9.5"  | 5' 7.5"     | 4' 10.5"      | 5' 10"         | 6'                | 3' 5.5"                |
| (E) Kingpin to Axle                         | 29' 8.5" | 39' 3"      | 42' 7.5"      | 49' 8.5"       | 45'               | 30' 9.5"               |
| (F) Kingpin to Conveyor End                 | 59' 4.5" | 79' 1.5"    | 63' 7.5"      | 74' 5.54"      | 67' 3"            | 67' 5.5"               |
| Axle Weight (lbs.)                          | 8,000    | 17,430      | 16,700        | 20,000         | 25,000            | 38,400                 |
| Kingpin Weight (lbs.)                       | 1,000    | 1,070       | 4,690         | 4,700          | 6,500             | 7,300                  |

Additional conveyor lengths available upon request.







## Self-Contained Stackers

### AN ENTIRELY DIFFERENT BREED OF SELF-CONTAINED STACKERS

Designed and built entirely by Masaba, these road-portable and pit-portable Stackers are powered by a 72 HP Yanmar onboard diesel-powered hydraulic unit, making them perfect for remote operations. Self-Contained Hydraulic Radial Stackers are constructed to the same high standards as Masaba's traditional Stackers, ensuring durability without compromising on quality or using lighter steel and unbranded components.

These Self-Contained Stackers currently come in a standard belt width of 36 inches and lengths of 80 and 100 feet. Additional lengths will be offered in the future, and we are happy to work with customers seeking custom widths and lengths. The current line of Self-Contained models provides a capacity of 500 TPH at an 18° incline.

|                      |                |             |
|----------------------|----------------|-------------|
| <b>Belt Width</b>    | <b>36"</b>     |             |
| <b>Max Capacity</b>  | <b>500 TPH</b> |             |
| <b>Length</b>        | <b>80'</b>     | <b>100'</b> |
| <b>Dimension "A"</b> | 77' 8"         | 93' 4"      |
| <b>Dimension "B"</b> | 40' 11"        | 48' 10"     |
| <b>Dimension "C"</b> | 27' 5"         | 33' 9"      |

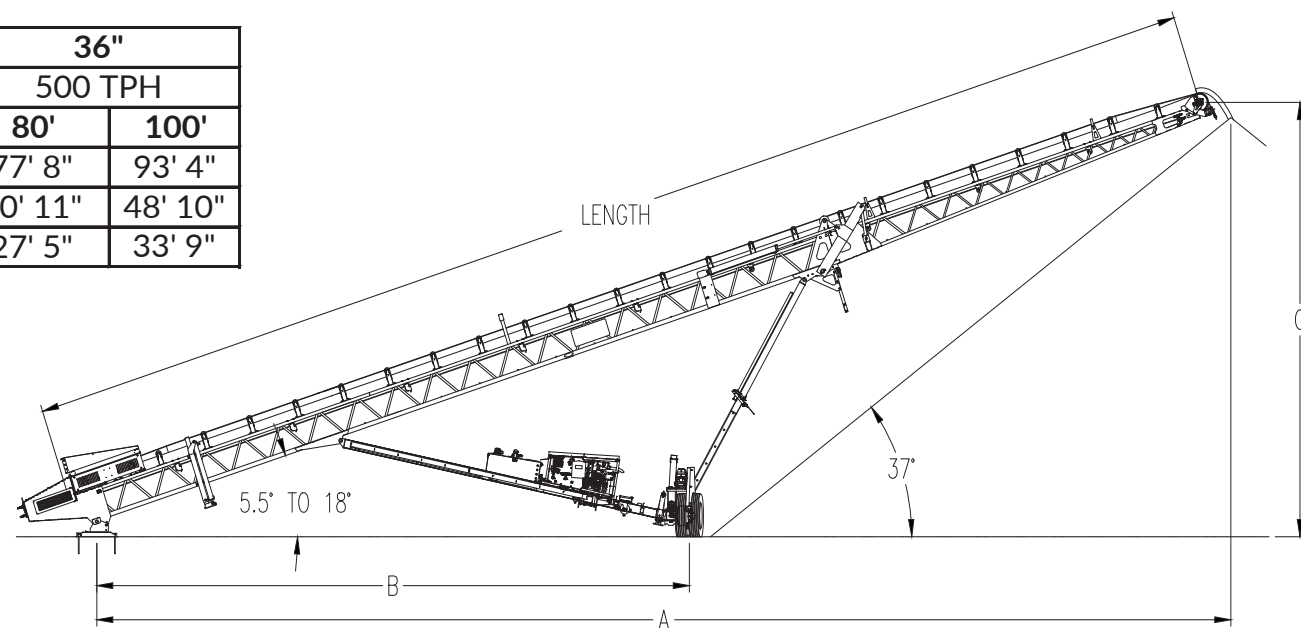

## Roll-Off & Stackable Conveyors

When effective pit management is essential, Masaba Roll-Off or Stackable Conveyors provide efficient transfer solutions. Their easy unloading and quick setup make these road-portable conveyors ideal for the fast-paced demands of the modern mining industry. They can be configured as either pit-portable or stationary to suit your needs.

### Standard Roll-Off & Stackable Sizes:

- » 36" x 60', 36" x 70'
- » 3-Pack Stackable 36" x 60'

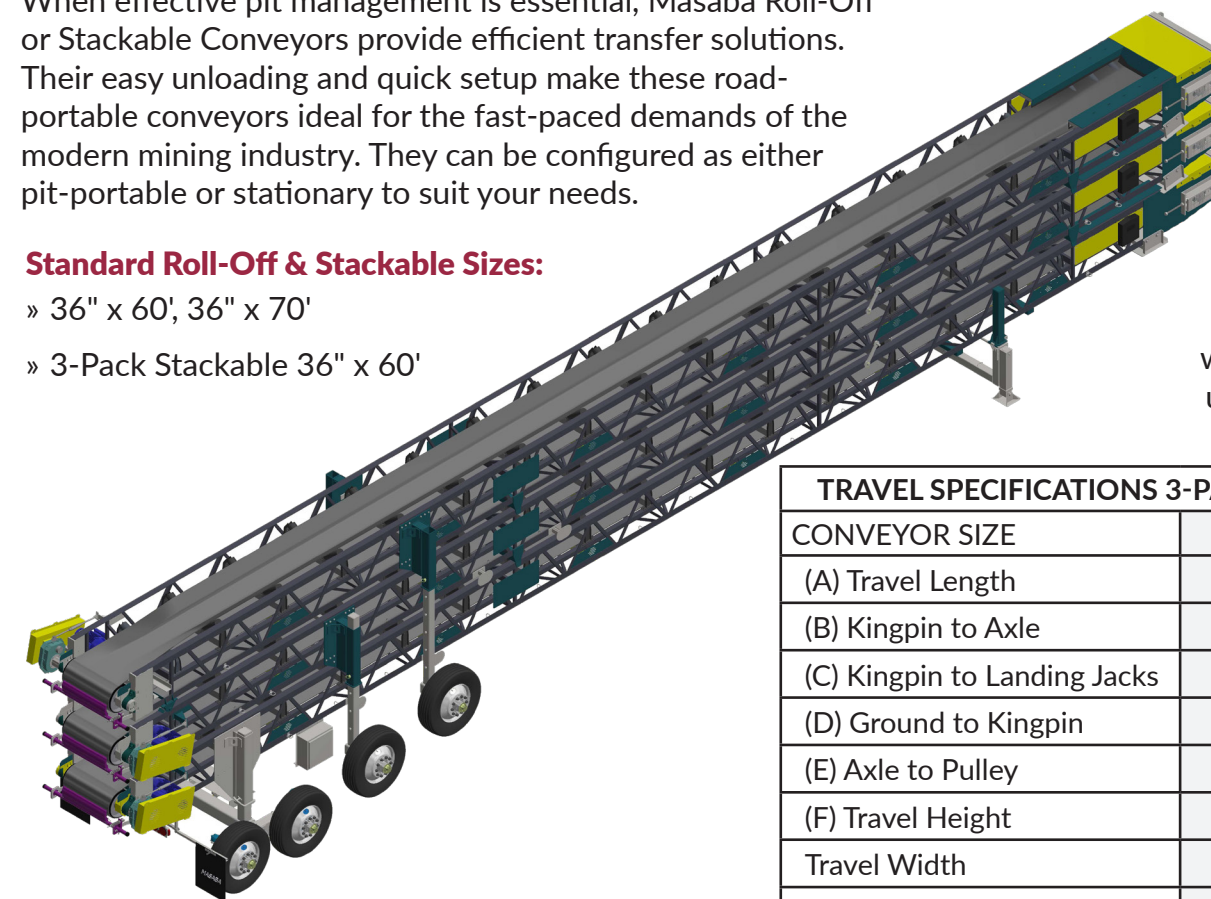

Scan the QR code to watch a video on the ease of unloading a Masaba 3-pack.

| TRAVEL SPECIFICATIONS 3-PACK ROLL-OFF TRANSFERS |            |            |
|---|------------|------------|
| CONVEYOR SIZE                                   | 36" x 60'  | 36" x 70'  |
| (A) Travel Length                               | 63' 1.5"   | 73' 6"     |
| (B) Kingpin to Axle                             | 40' 2.5"   | 60' 1"     |
| (C) Kingpin to Landing Jacks                    | 8' 5.5"    | 7' 5"      |
| (D) Ground to Kingpin                           | 4' 2"      | 4' 2"      |
| (E) Axle to Pulley                              | 19' 4"     | 8' 5.5"    |
| (F) Travel Height                               | 13' 6"     | 13' 2"     |
| Travel Width                                    | 11' 11"    | 10' 11"    |
| Weight at Axle                                  | 28,600 lbs | 23,900 lbs |
| Weight at Kingpin                               | 11,300 lbs | 16,200 lbs |





## Sand Wagons

Masaba Sand Wagons are designed for the agriculture industry, particularly for efficient handling and distribution of sand used in livestock operations. Ideal for bedding in dairy barns or similar applications, these wagons provide a reliable and durable solution for transporting and spreading sand with ease.

Designed and built with Masaba's commitment to quality, Sand Wagons are engineered to withstand the demands of agricultural applications, helping farmers save time and effort while maintaining a clean, comfortable environment for their livestock.

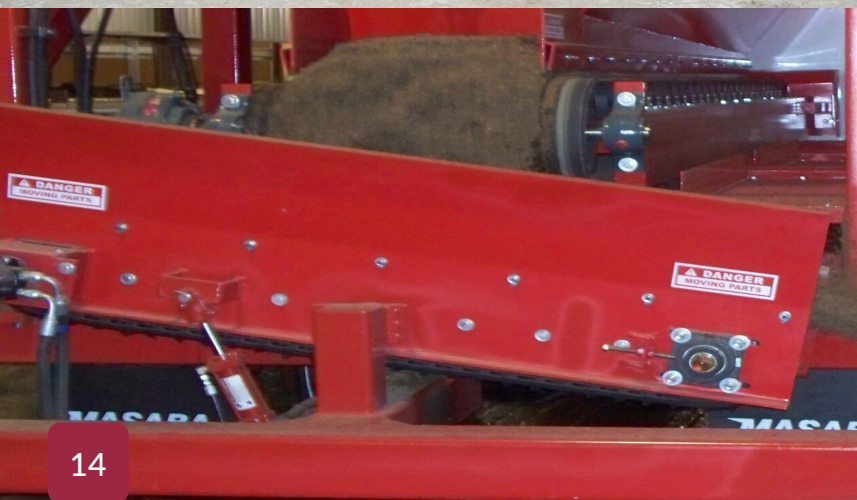

## Bins, Hoppers, & Feeders

Masaba's Bin Plants are fully portable, featuring detachable 9' x 14' Hoppers that reduce transportation costs and enhance mobility. An optional fourth bin is available. The 3-Bin Plants accommodate stacking of 30" belt width conveyors in lengths of 60' or 70', while the 4-Bin Plants can handle 30" belt width conveyors in lengths of 85'.

Masaba Feeders are equipped with self-cleaning grizzly bars to ensure continuous material flow and prevent buildup. Enhance your crushing and screening operation by maximizing output with Masaba's Bins, Hoppers, and Feeders.







## Crushing Plants

Masaba Crushing Plants are designed to be road-portable, with options for pit portability or stationary installation. These plants provide the strength and versatility required for your specific application.

Standardize your crushing plant with industry-leading components, or we can create a fully customizable plant that accommodates any crusher you choose.

### Some Crushing Plant Options Include:

- » Jaw Plants      » HSI Plants
- » Cone Plants    » VSI Plants



## Screen Plants

For efficient and reliable material sorting, nothing compares to a Masaba Screen Plant. Starting with a robust chassis, Masaba engineers collaborate with you to find your optimal solution. Masaba Screen Plants are constructed on a heavy-duty wide-flange beam chassis to withstand the toughest conditions. Offering precision screening and mobility, they are designed to be road-portable, with options for in-pit portability or stationary installation.

### Standard Screen Sizes:

- » 6x20    » 8x20
- » 7x20    » Single and Dual Screen Plants Available







## Wash Plants

Process your aggregate material wherever the opportunity arises with a Masaba portable or stationary Wash Plant. These washing and screening plants blend the efficiency and productivity of custom Fine Material Washers with the proven toughness and durability of Masaba Chassis and Conveyors. Masaba's Wash Plants allow you to pair your choice of Wash Screen with any Masaba Fine Material Washer.

### Standard Wash Plant Sizes

- » 5x16 over Single 36" FMW
- » 6x20 over Twin 36" FMW
- » 6x20 over Twin 44" FMW
- » 7x20 over Twin 44" FMW



## Fine Material Washers

Masaba's Fine Material Washers (FMWs) efficiently clean and dewater fine aggregates, such as sand, by removing silt, clay, and debris. Built with heavy-duty construction, they ensure durability and high-capacity performance in tough applications. Ideal for construction, aggregates, and mining, FMWs are available in various sizes and configurations to meet specific needs, and they integrate seamlessly with Masaba's Wash Plants. Masaba FMWs provide a reliable solution for producing clean, high-quality materials that meet industry standards.

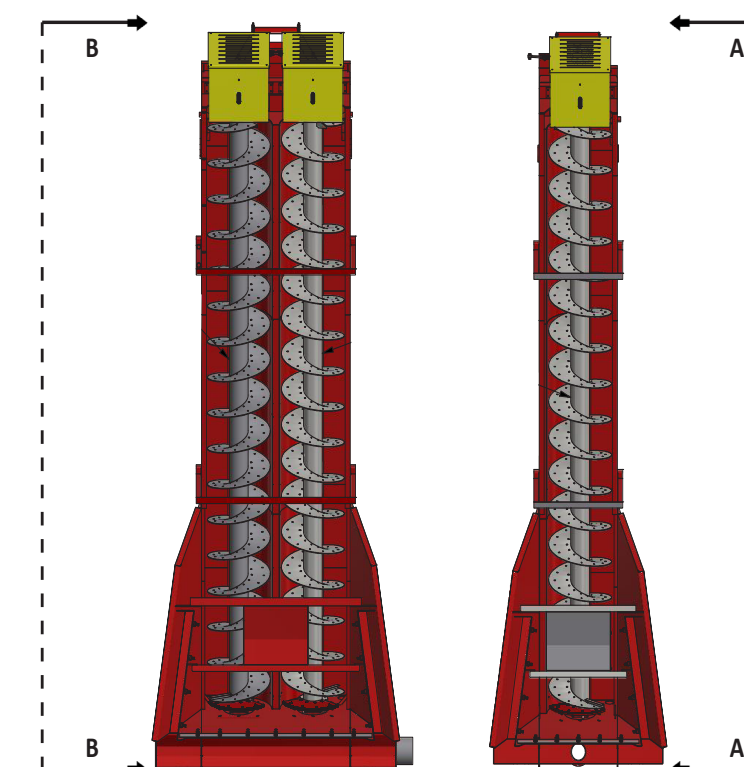

### Standard Fine Material Washer Sizes

- » 36"
- » 44"
- » 54"
- » All Options Available in Single or Twin

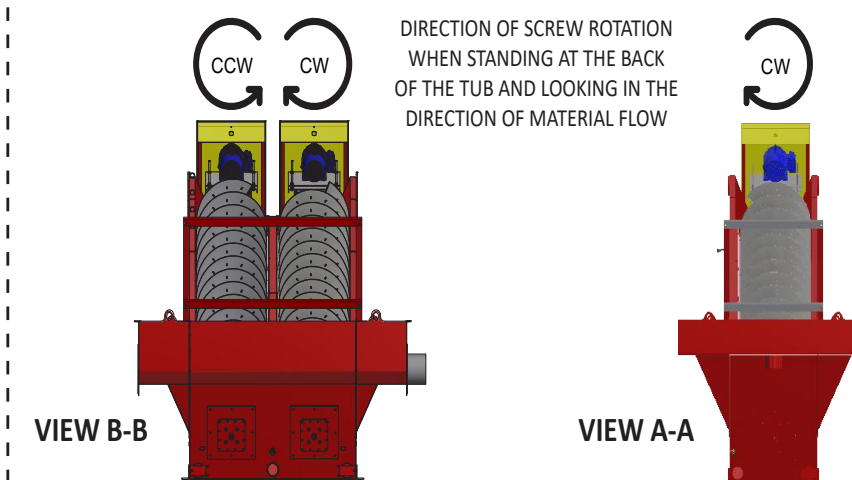





Custom Conveyors



Custom Plants







Masaba Dealer Network

Service, Support, & Parts

**PARTNERS — WHEREVER YOU NEED THEM**

Masaba’s dealer network comprises partners in nearly all 50 states, as well as select international locations. If you’re unable to locate a dealer in your area, please reach out to us directly!

**FIND THE CERTIFIED DEALER IN YOUR REGION**

Scan the QR code below to go to our *Find a Dealer* page.

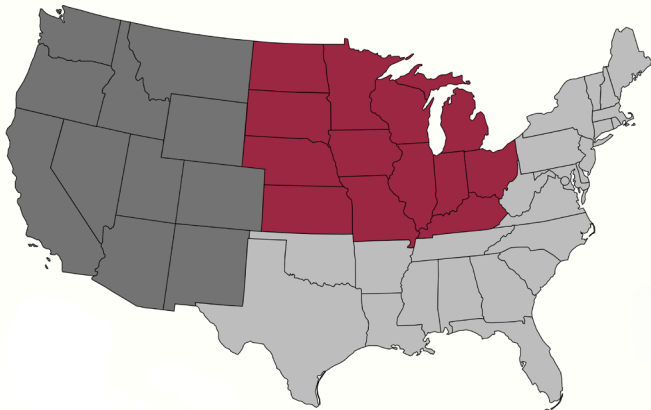

**CONTACT A MASABA OUTSIDE SALES REP (U.S. REGIONS)**



**Kirby Cline**  
Northwest & Southwest



**Kevin Glendenning**  
Midwest



**Andrew Wells**  
Southeast & Northeast

**INTERESTED IN BECOMING A CERTIFIED MASABA DEALER?**

Contact us today about opportunities and availability.

**A PROMISE OF SERVICE**

Masaba is dedicated to delivering exceptional customer support in all facets of our business relationships with our partners.

At Masaba, we back our new equipment with a five-year structural warranty and a two-year component warranty. Our commitment is to provide customers with the highest quality products and support available in the market today.

**ONSITE SUPPORT**

Our experienced field service team and dealer representatives offer onsite support tailored to your operation. As a dedicated service provider, our production team is focused on enhancing process performance, boosting productivity, and ensuring maximum plant availability. Our service team is committed to delivering reliable equipment performance, effective preventive maintenance, and improved safety.

**PARTS**

We understand that your business requires more than just a quality product; that’s why you can rely on Masaba. With extensive inventories of parts stored in our warehouse and at various dealer locations, we strive to minimize downtime when you need to replace a part. Reach out to the Masaba parts department for wear items, spare parts, and replacements for your Masaba equipment.

- » Bearings
- » Belt Scrapers
- » Bushings
- » Conveyor Belts
- » Electrical Components (Switch Gear)
- » Electric Motors
- » Guards (Manufactured by Masaba to specifications)
- » Hydraulic Cylinders
- » Hydraulic Power Units
- » Hydraulic Pumps
- » Idlers
- » Masaba “Brute” Jacks
- » Pulleys
- » Reducers
- » Shafts
- » V-Belts



**5-Year  
2-Year  
WARRANTY**

Complete Structural  
Complete Equipment

**CONTACT US**

Masaba, Inc.  
1617 317th Street | PO Box 345  
Vermillion, SD 57069

**Inside Sales**  
877-627-2220  
605-624-9555  
sales@masabainc.com

**Service & Support**  
605-670-9496  
customercare@masabainc.com

**Parts**  
605-658-8948  
parts@masabainc.com





1617 317TH STREET  
PO BOX 345  
VERMILLION, SD 57069

## MOVING YOUR BUSINESS **FORWARD**



### **Masaba, Inc.**

1617 317th Street | PO Box 345  
Vermillion, SD 57069  
Toll Free: 877-627-2220  
Direct: 605-624-9555  
Fax: 605-624-9555  
Web: [masabainc.com](http://masabainc.com)



[www.facebook.com/masabainc](https://www.facebook.com/masabainc)



[www.youtube.com/@masaba-inc](https://www.youtube.com/@masaba-inc)



[www.linkedin.com/company/masaba-inc](https://www.linkedin.com/company/masaba-inc)



[www.instagram.com/masabainc](https://www.instagram.com/masabainc)



[www.tiktok.com/@masabainc](https://www.tiktok.com/@masabainc)

### **Masaba Canada**

827501 Grey Rd. 40  
Blue Mountains, Ontario N0H 1J0  
Phone: 519-599-3100  
Fax: 519-599-0999  
Web: [masaba.ca](http://masaba.ca)